



**KADIPA**  
KADUNA INVESTMENT  
PROMOTION AGENCY

# KANGIMI

MIXED AGRICULTURAL/ RESIDENTIAL LAYOUT

## BRIEF

The Kangimi Mixed Agricultural/Residential Layout is a proposed Agricultural and Agro allied layout of about 903.64 Ha of land. The layout has several land use plots planned for various purpose such as Residential, Agricultural, Industrial, Commercial, and other agro allied businesses.

### THE LAYOUT WILL PROVIDE THE FOLLOWING INVESTMENT OPPURTUNITIES:

S/N	LAND USE	PURPOSE	Total No. of Plots	Investment opportunities
1	<b>Residential</b>	<ul style="list-style-type: none"> <li>❖ Private Residential</li> <li>❖ Mass Housing</li> </ul>	273	<ul style="list-style-type: none"> <li>❖ Private residential development</li> <li>❖ Affordable Mass Housing/Staff Quarters</li> </ul>
2	<b>Agricultural</b>	<ul style="list-style-type: none"> <li>❖ Farming</li> <li>❖ Horticulture</li> </ul>	160	<ul style="list-style-type: none"> <li>❖ Farming of crops such as sugarcane, yam, maize, soyabeans, cowpea, pepper etc.</li> </ul>
3	<b>Industrial</b>	<ul style="list-style-type: none"> <li>❖ Agro-allied industries</li> <li>❖ Service Industries</li> </ul>	10	<ul style="list-style-type: none"> <li>❖ Export of agricultural products</li> <li>❖ Development of agro-allied idustries like flourmills, rice mills, oil mill, breweries, Fruit juice factories etc.</li> <li>❖ Ranch</li> <li>❖ Poultry Farm</li> </ul>
4	<b>Commercial</b>	Commercial Use	7	<ul style="list-style-type: none"> <li>❖ Agri product market &amp; Retail Stores</li> <li>❖ Neighborhood centre</li> <li>❖ Warehousing of agricultural produce</li> <li>❖ Banks</li> <li>❖ Filling Stations</li> <li>❖ Commercial Institutions etc.</li> <li>❖ Cattle Market</li> </ul>
5	<b>Public facilities</b>	<ul style="list-style-type: none"> <li>❖ Public Institutions</li> <li>❖ Public Utility</li> </ul>	7	<ul style="list-style-type: none"> <li>❖ Nursery and primary school</li> <li>❖ Health clinic</li> <li>❖ Veterinary clinic</li> <li>❖ Place of worship</li> </ul>
6	<b>Others</b>	Stream	-	<ul style="list-style-type: none"> <li>❖ Fishery with streams in the area or with artificial ponds that can tap into the Kangimi dam.</li> </ul>
		<b>Total</b>	<b>457</b>	

## Why Invest In This Layout?

- The layout is close to the Kangimi dam which may be used to support irrigation, flood control and water supply.



- Proximity to Tomato jos and Green Economic Zone which will enhance market and trading opportunities.





## Why Invest In This Layout?

- The layout has a stream which may be used to aid fishery.



- The agricultural layout is surrounded by many towns and suburbs where the natives are all farmers, this will provide the workforce and market for trading agricultural produce.





## Why Invest In This Layout?

- The layout is close to the Kaduna Inland Dry Port which eases export of produce from the layout.



- The layout is situated close to the ZariaKano highway which is the gateway to the Northern market.



## Why Invest In This Layout?

- The layout is situated between Plateau State and Kaduna State which provides a favorable weather for farming.

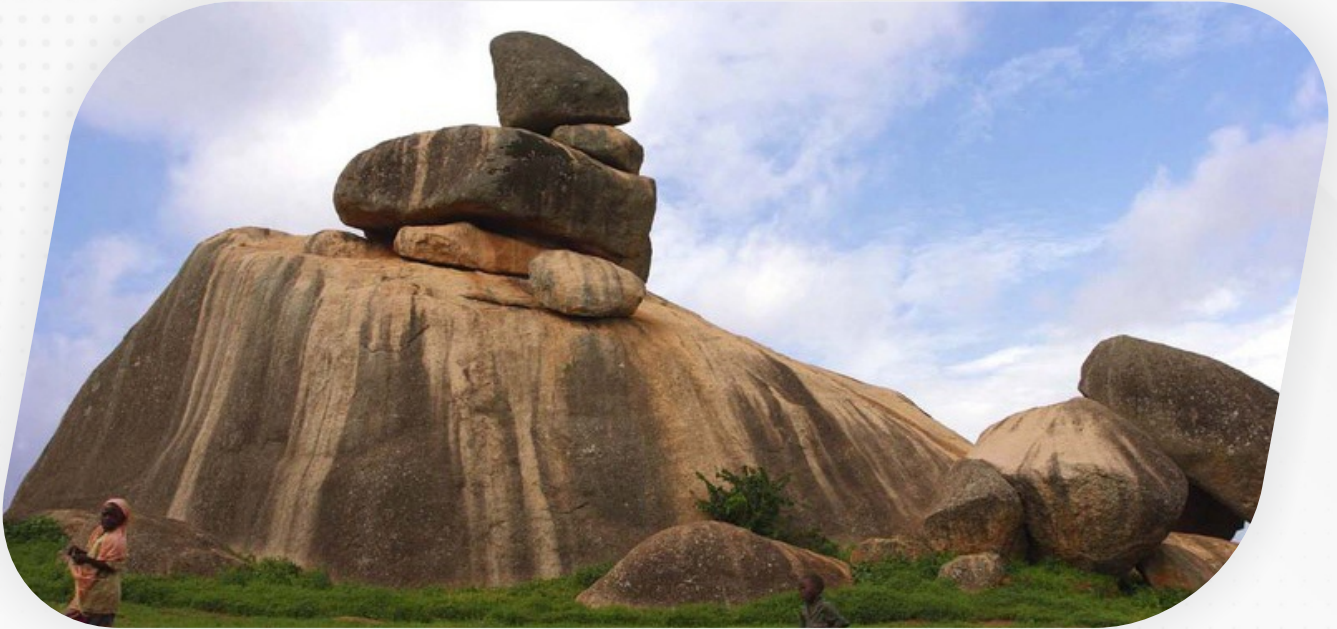



# PROPOSED MIXED AGRICULTURAL/RESIDENTIAL LAYOUT

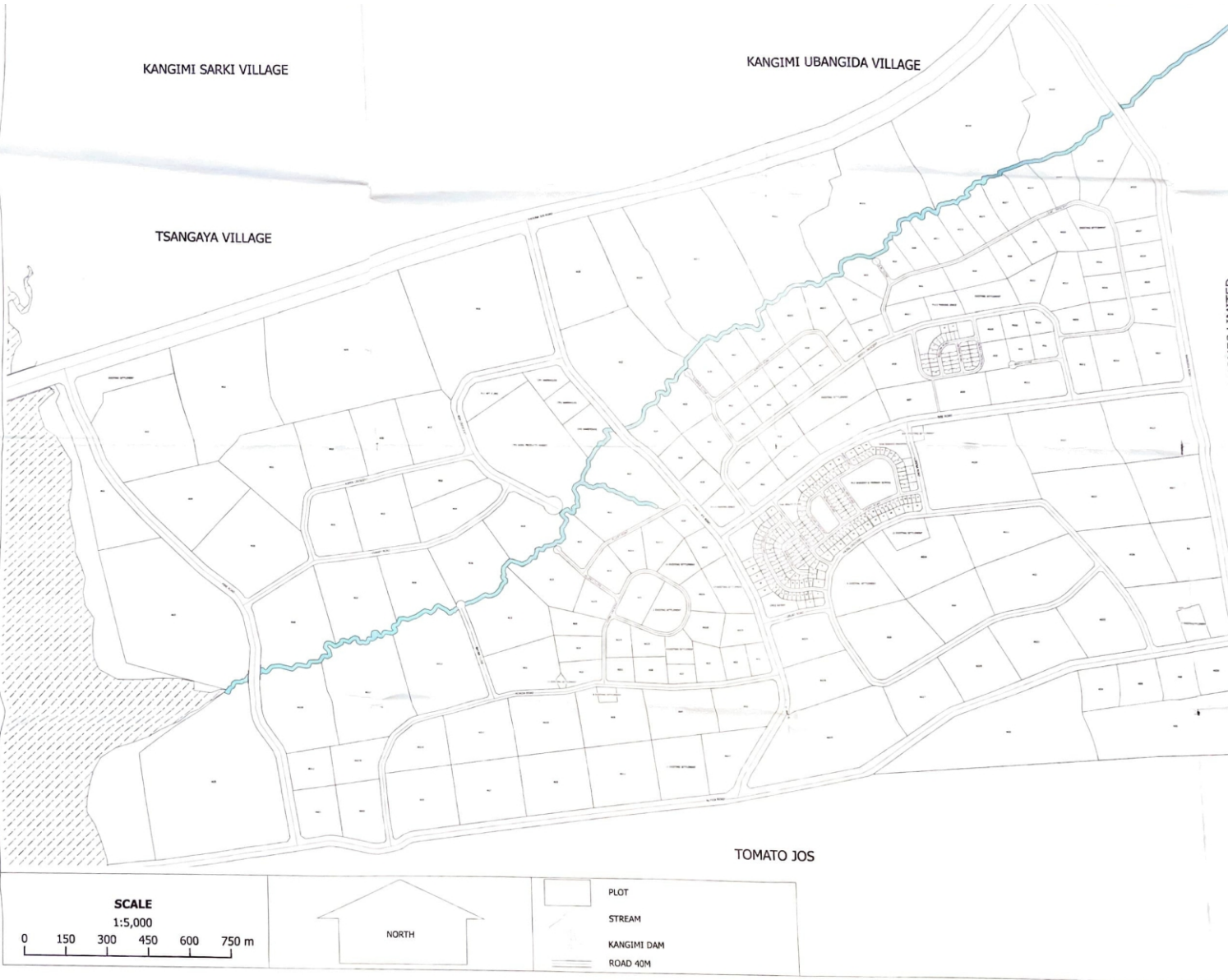



# **KANGIMI**

**MIXED AGRICULTURAL/RESIDENTIAL LAYOUT**